

# Sfogliato strutturale della Copertura

Individuazione delle zone interessate da estesi fenomeni di degrado, identificazione delle patologie di degrado più significative e rilievo delle capriate

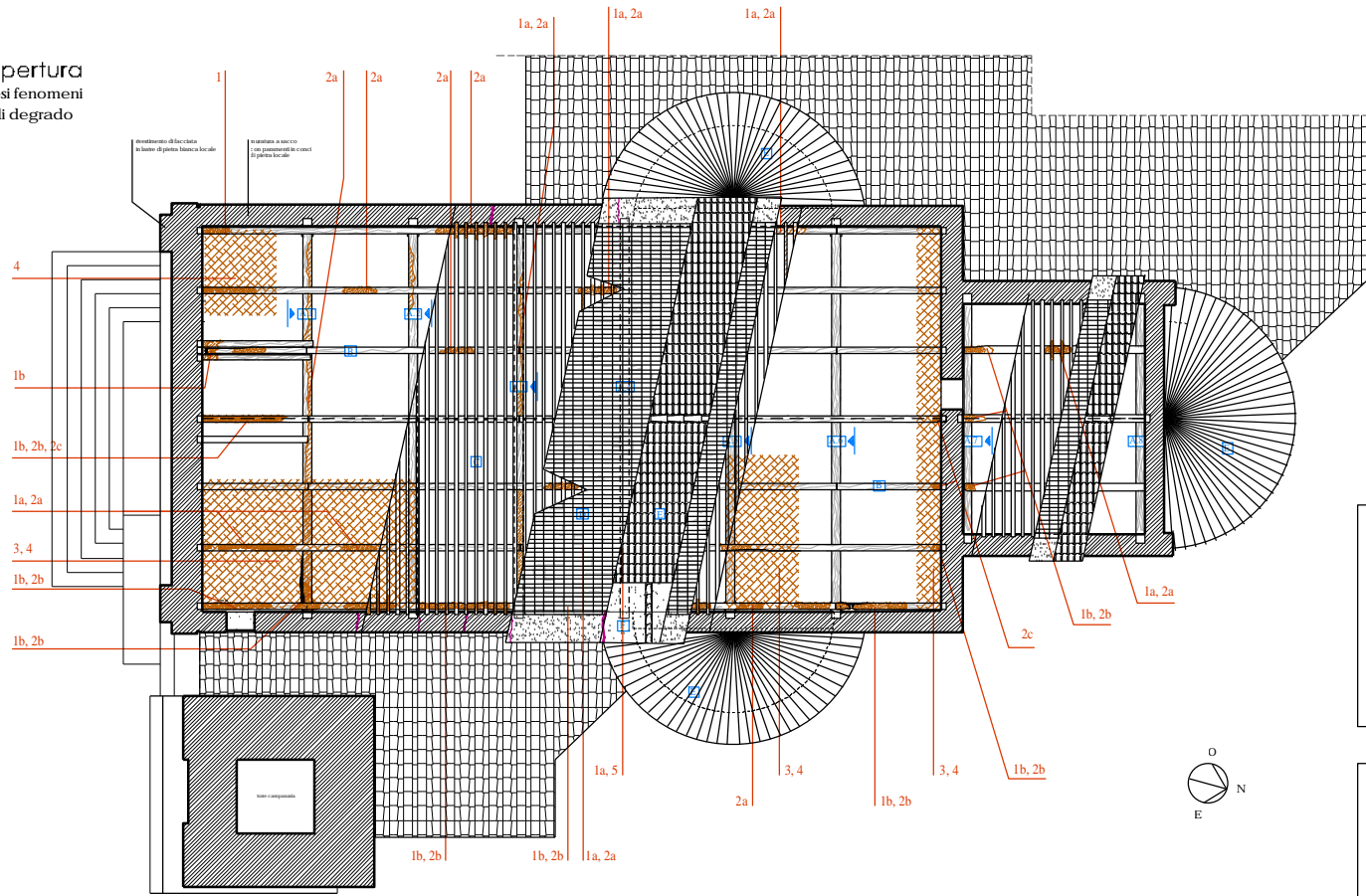

## RILIEVO DEL DEGRADO (ORDINE LETTERE)

- 1a - Marcescenza, indebolimento e scissione della struttura portante primaria e secondaria (causata da persistenti infiltrazioni d'acqua piovana)
- 1b - Marcescenza e indebolimento irreversibile della struttura portante primaria e secondaria (causata da persistenti infiltrazioni d'acqua piovana)
- 2a - Degrado superficiale da attacco biologico della struttura portante primaria e secondaria (causata da insetti alofagi, muffe e funghi)
- 2b - Degrado profondo da attacco biologico della struttura portante primaria e secondaria (causata da muffe e funghi)
- 2c - Degrado profondo da attacco biologico della struttura portante primaria e secondaria (causata da insetti alofagi)
- 3 - Inflexione accentuata della struttura portante terziaria (correntini) (causata da persistenti infiltrazioni d'acqua piovana)
- 4 - Sconnessioni, lacune e caduta delle tavole in cotto (causate dall'inflexione dei correntini)
- 5 - Presenza di punteili

- MURATURA PORTANTE A SACCO CON PARAMENTI IN BOZZE DI PIETRA LOCALE
- LESIONI MERIDIE PASSANTI
- DETERIORAZIONE LEGNEA (primaria e secondaria)
- PRESSIONE DI DEGRADO FISICO
- LOCALIZZAZIONE DELLE ZONE AMPARMENTE DEGRADATE

## COMPOSIZIONE DELLA STRUTTURA DI COPERTURA

- A - Orditura primaria (capriate)
- B - Orditura secondaria (caracac-c)
- C - Orditura terziaria (correntini, 6x7cm)
- D - Tavole in cotto
- E - Manto in coppi a canale
- F - Lastre in Lastame

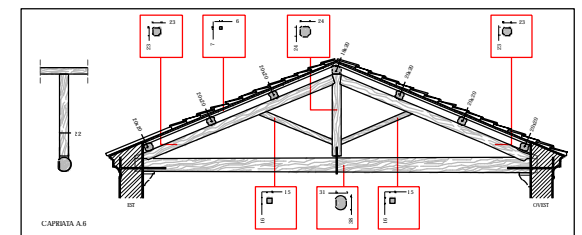
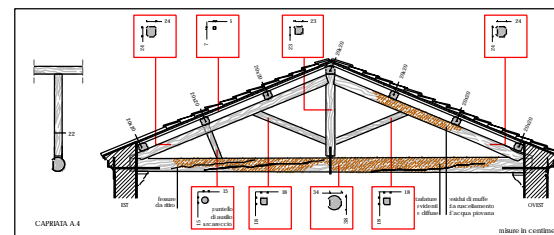
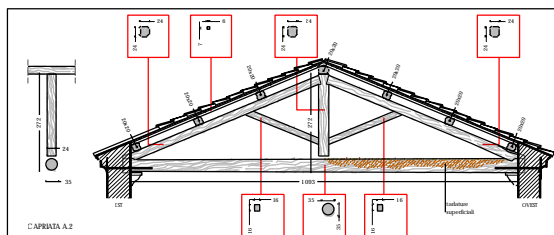
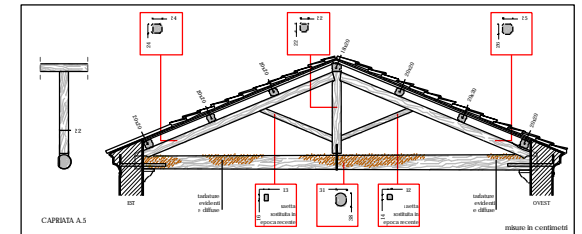
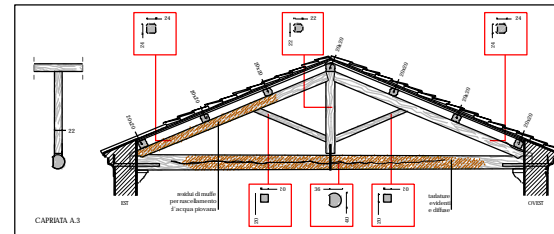
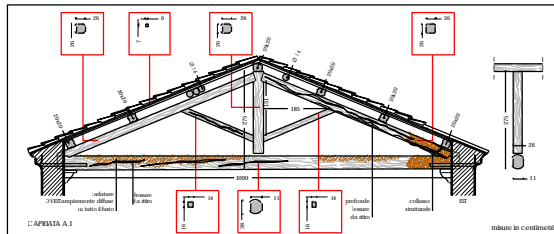
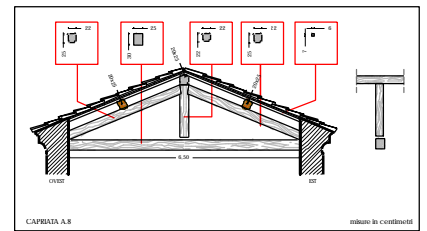
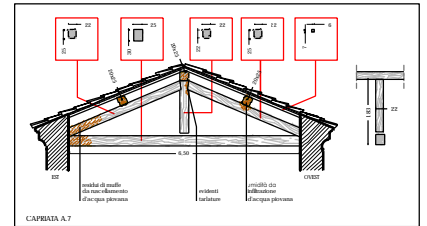

# Sfogliato strutturale della Copertura

## Descrizione degli Interventi e Dettagli costruttivi

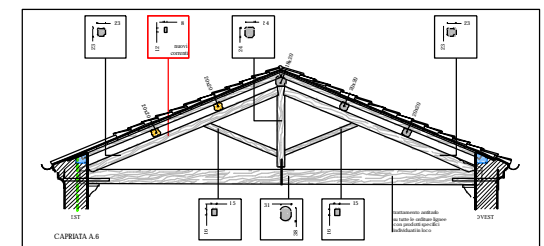
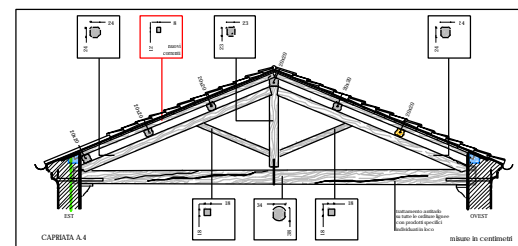
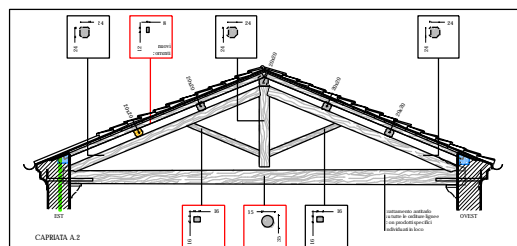
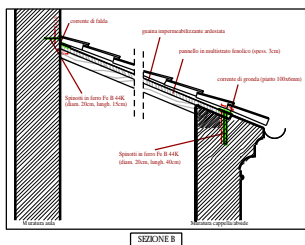
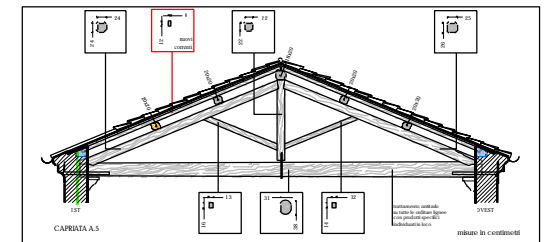
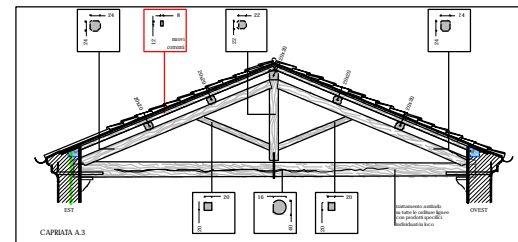
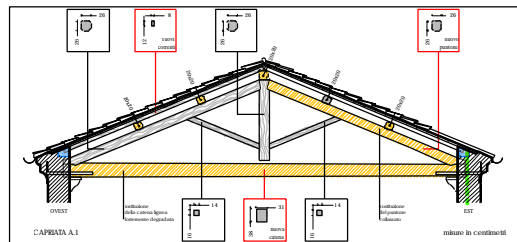
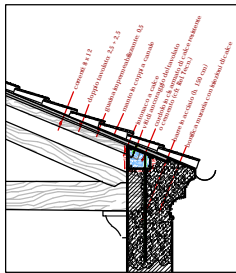
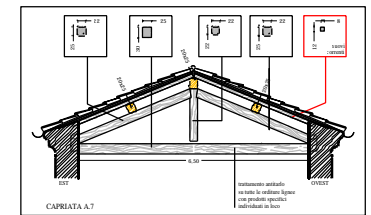
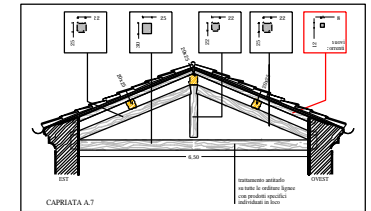
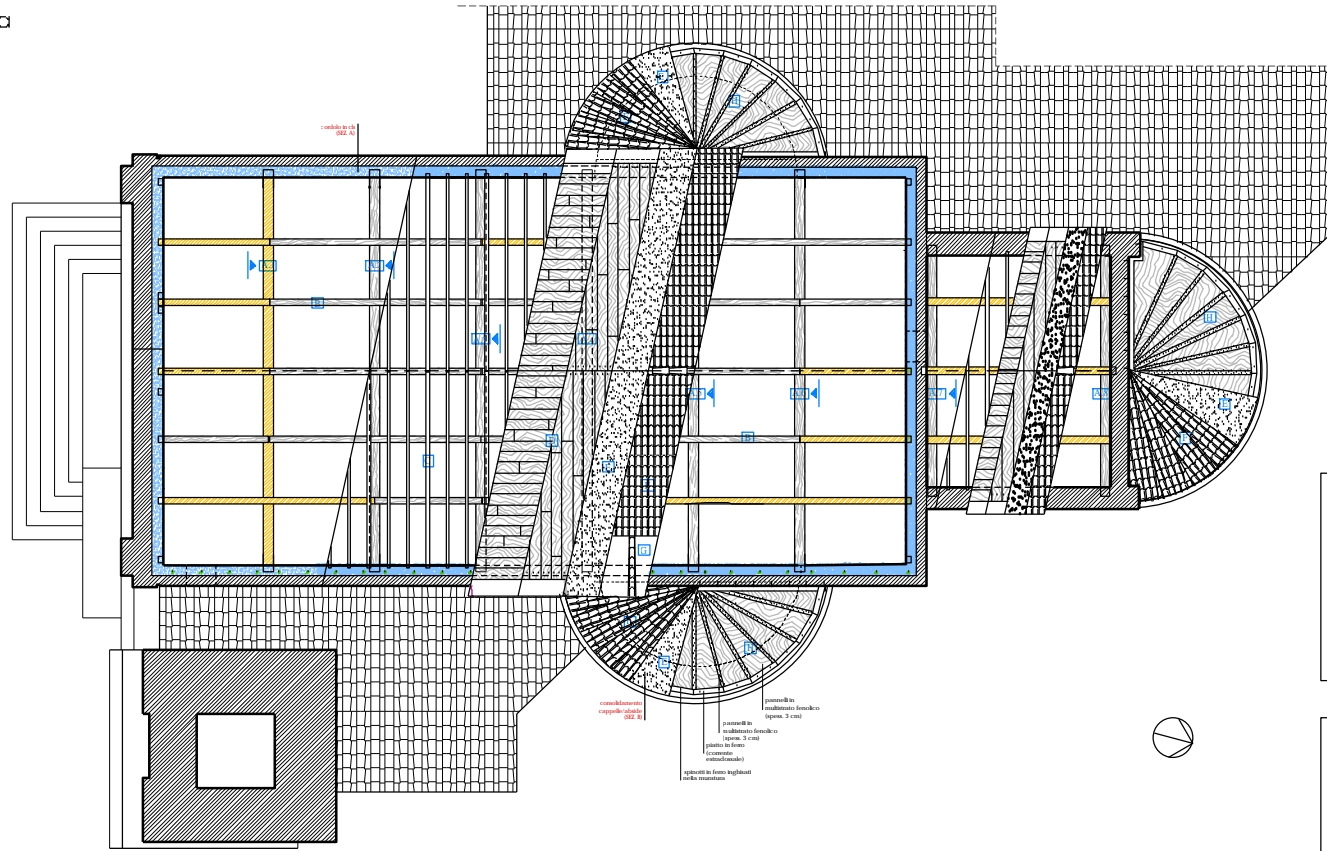

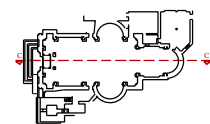
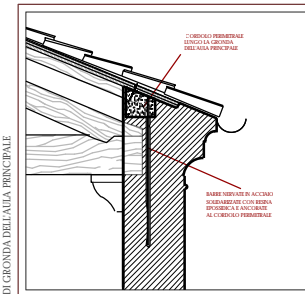
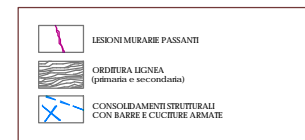
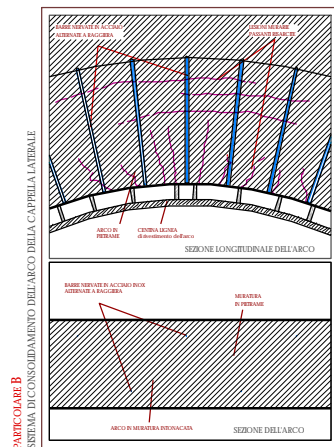
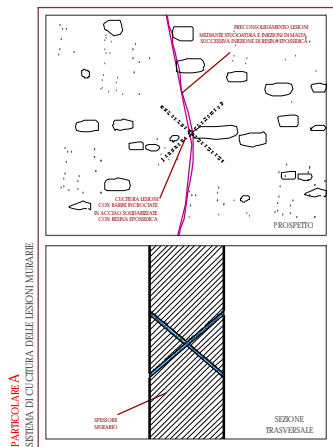
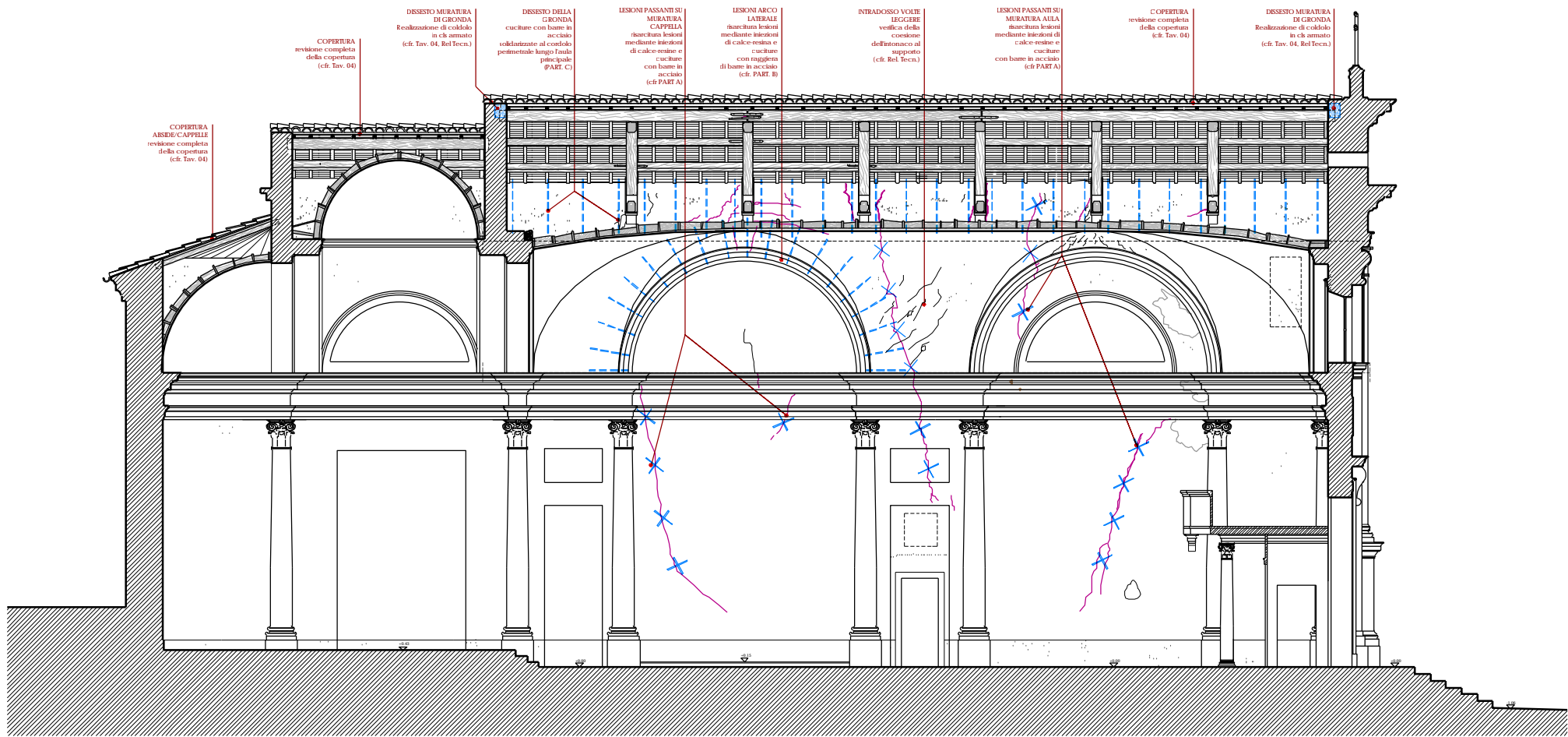

Sezione est longitudinale