

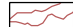



-  quadro fessurativo principale
-  quadro fessurativo secondario
-  evidenti distacchi del corpo intonaco/camiccio dalle centine
-  fasce verticali lesionate



Sviluppo piano dell'intradosso della finta volta nella chiesa parrocchiale di Sant' Ambrogio (stato ante restauro)

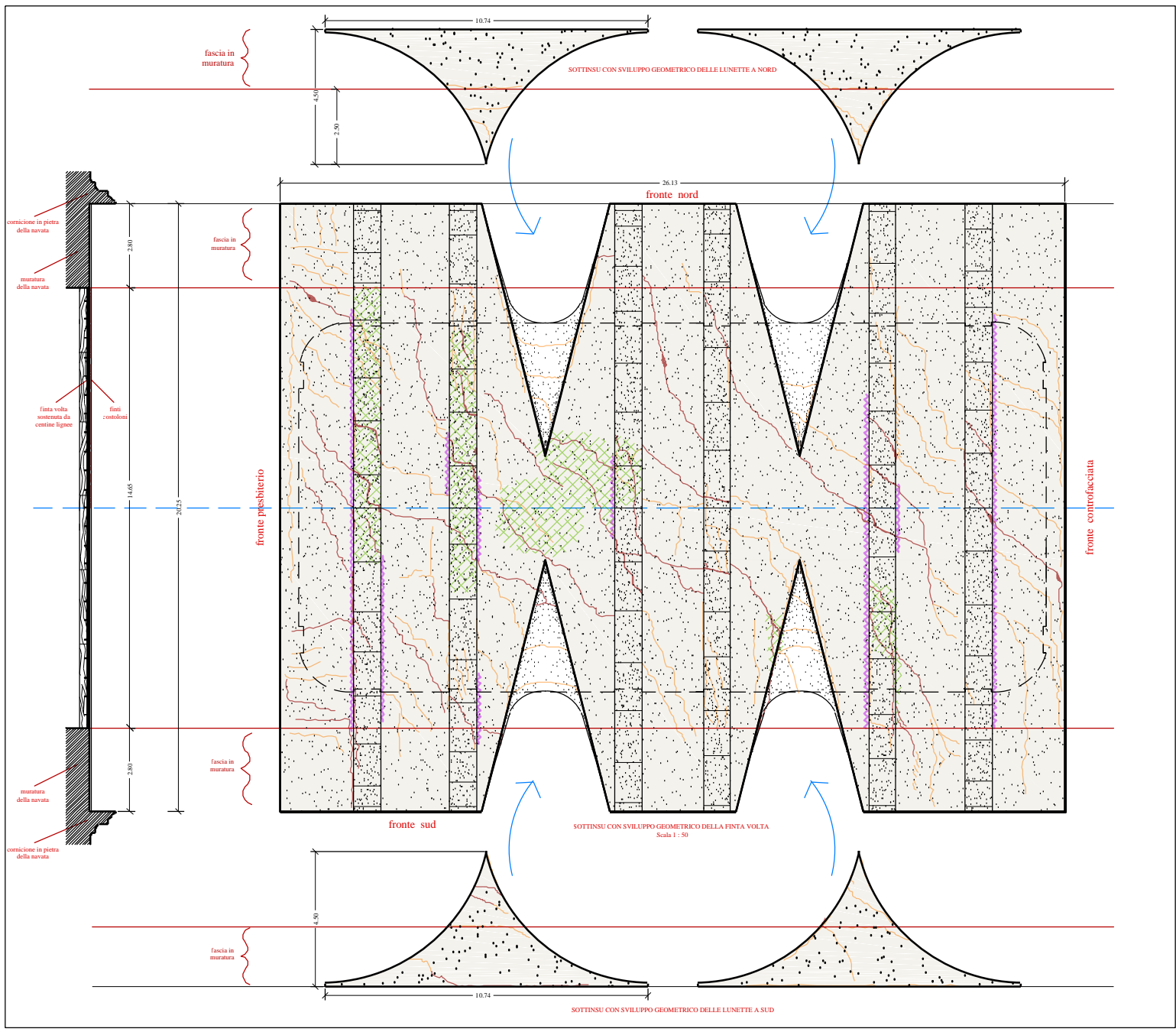
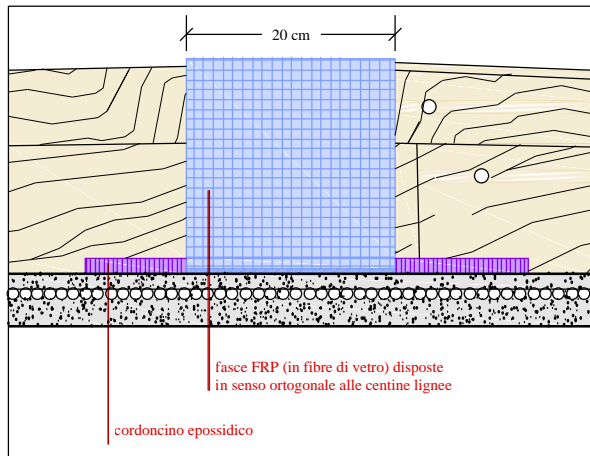

DETTAGLIO LATERALE SINISTRO

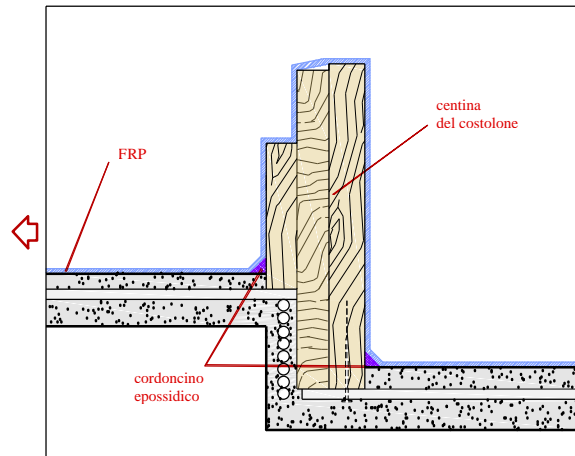

SEZIONE

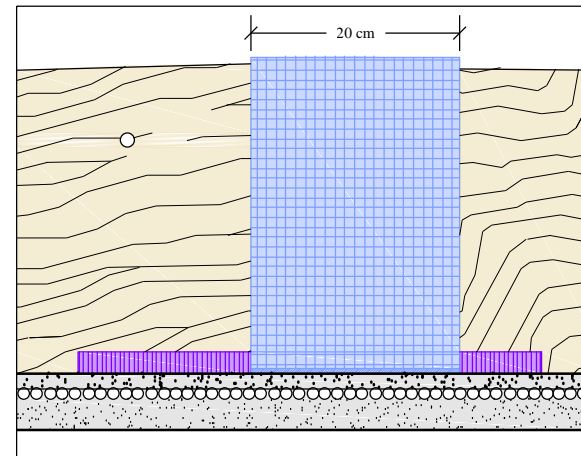

DETTAGLIO LATERALE DESTRO

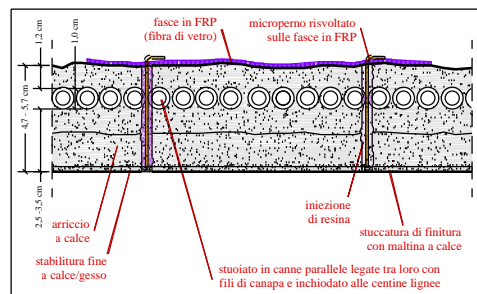



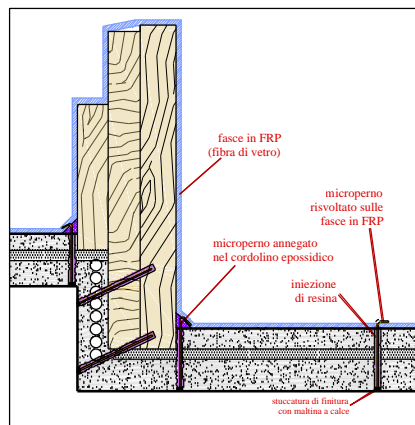

PARTICOLARE DELLA POSA DEI MICROPERNI

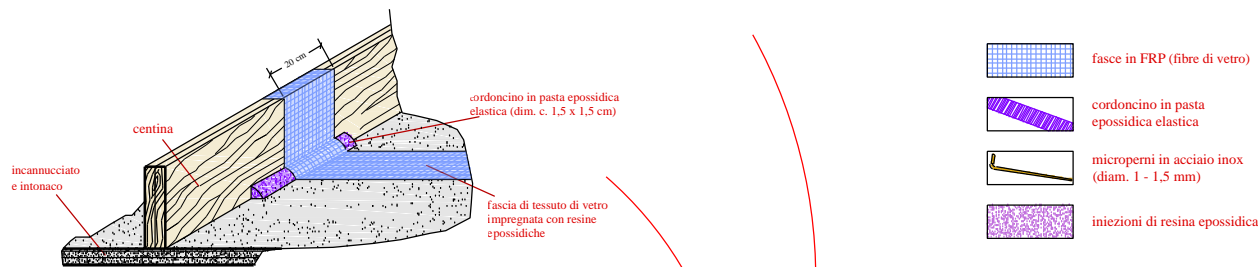

PARTICOLARE DELLA POSA DEI MICROPERNI SUI COSTOLONI

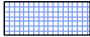
SCHEMA DI ANCORAGGIO DELL'INTONACO E DELL'INCANNUCCIATO ALLE FASCE IN FRP MEDIANTE MICROPERNATURA



-  fascie in FRP (fibre di vetro)
-  cordoncino in pasta epossidica elastica
-  microperni in acciaio inox (diam. 1 - 1,5 mm)
-  iniezioni di resina epossidica

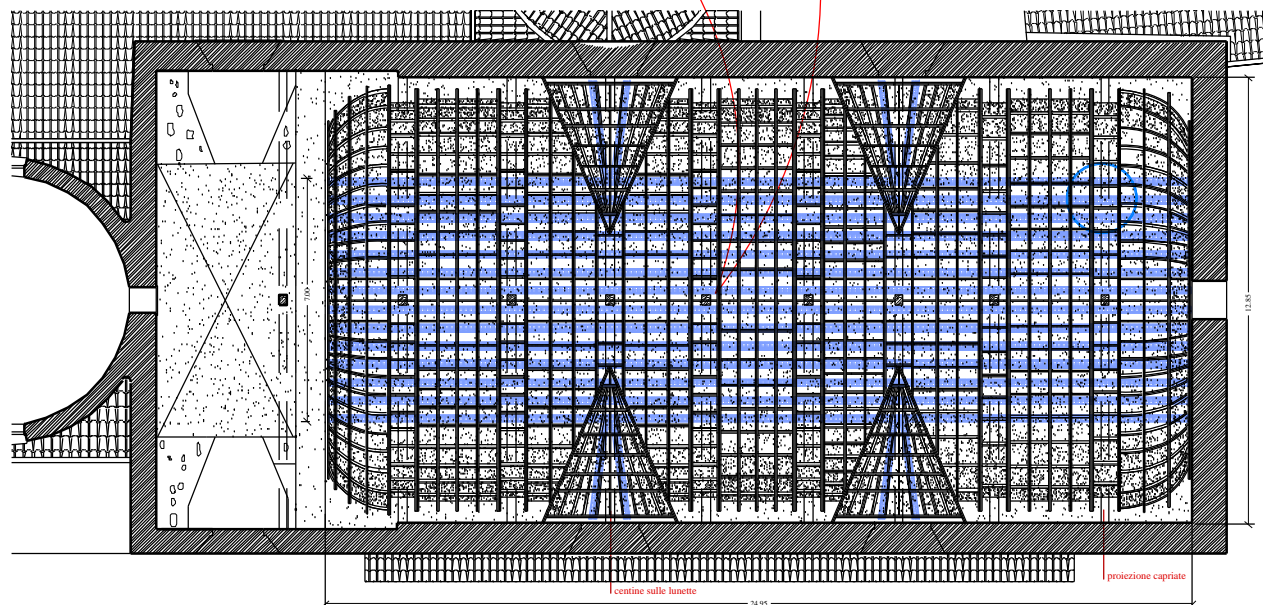

Dettagli esecutivi di progetto