

PARTICOLARE A SISTEMA DI CUCITURA DELLE LESIONI MURARIE

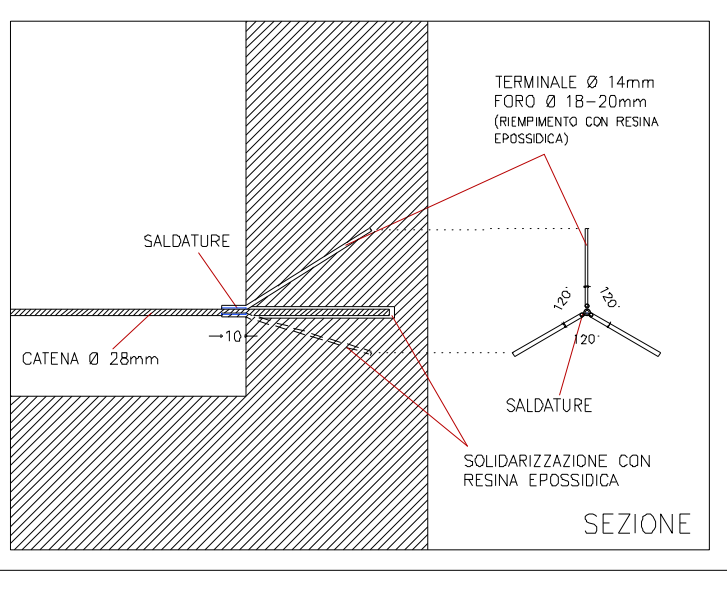

PARTICOLARE D TIRANTE IN ACCIAIO: TERMINALE A RADICE (POLIPO)

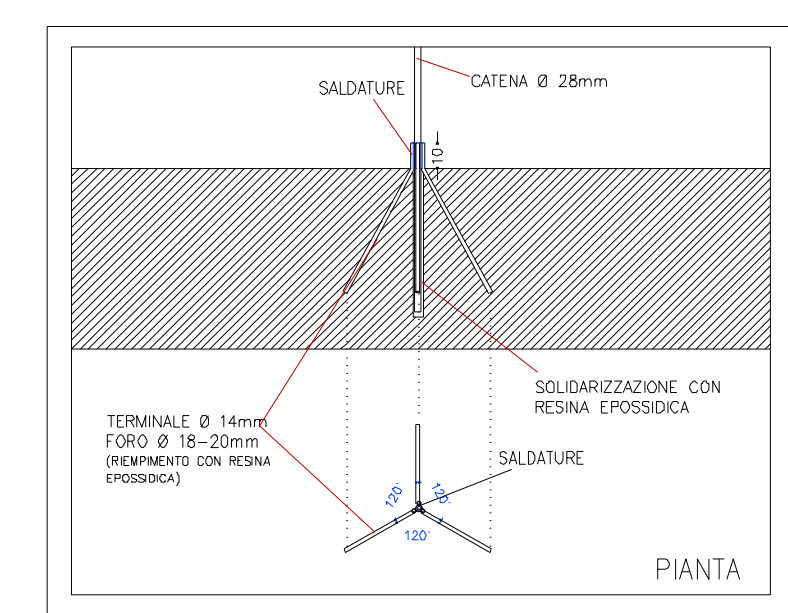
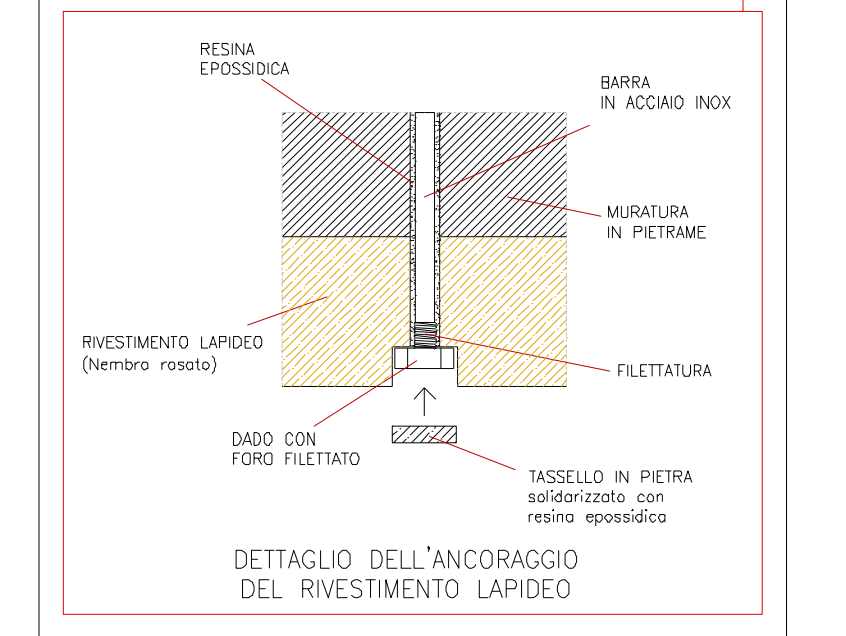
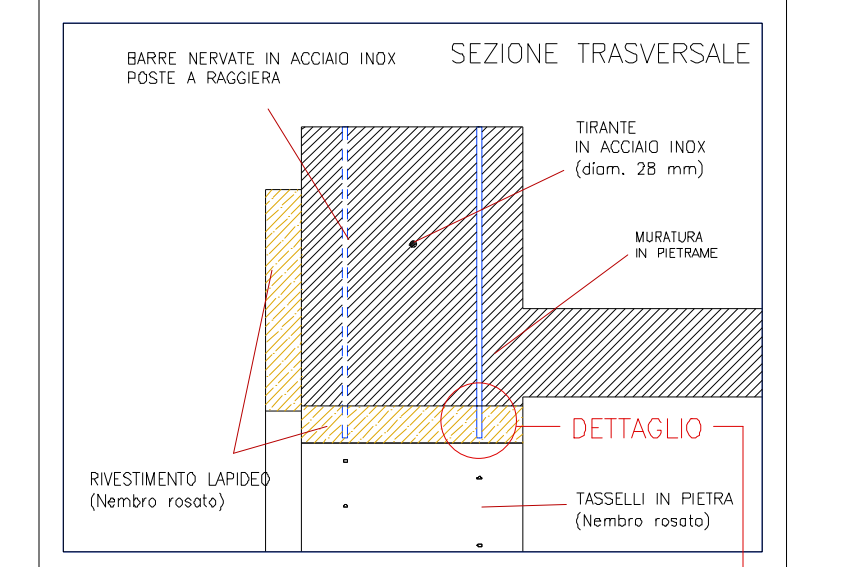
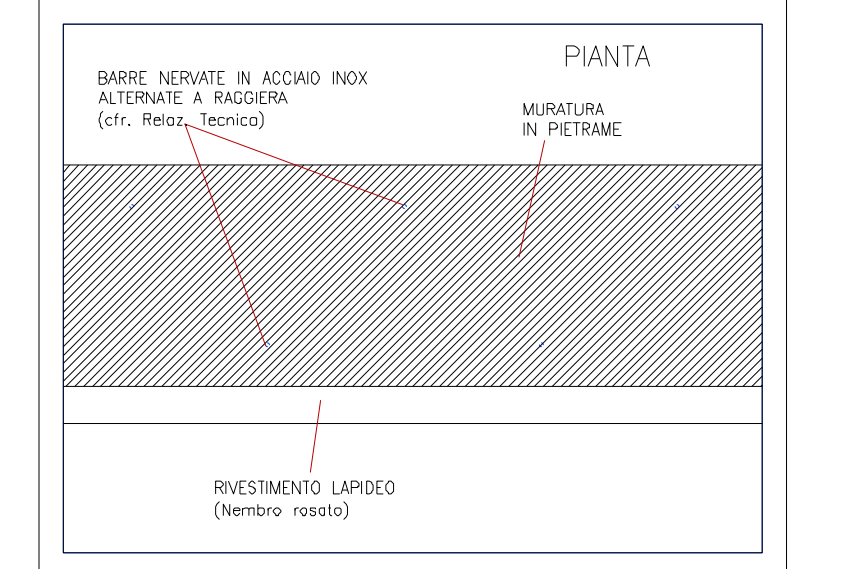
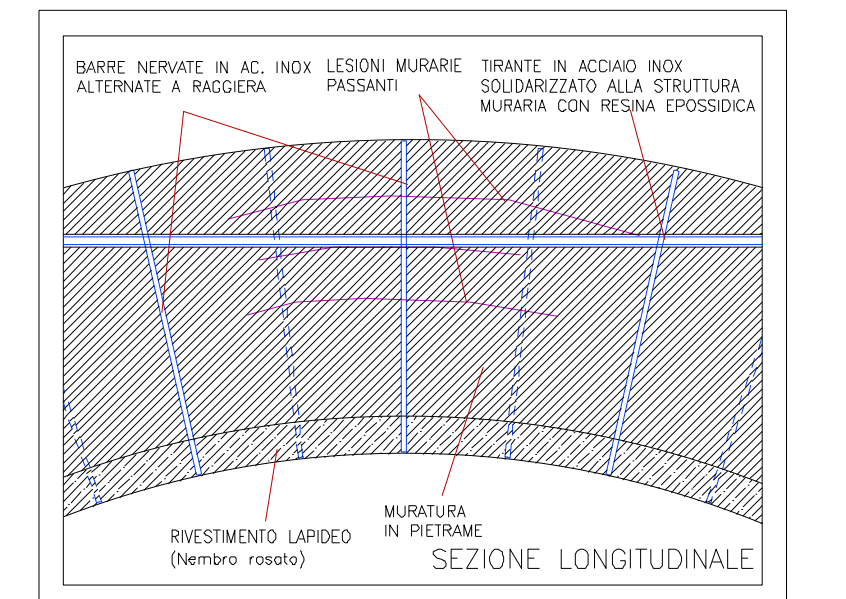

PARTICOLARE C SISTEMA DI CONSOLIDAMENTO DEGLI ARCHI

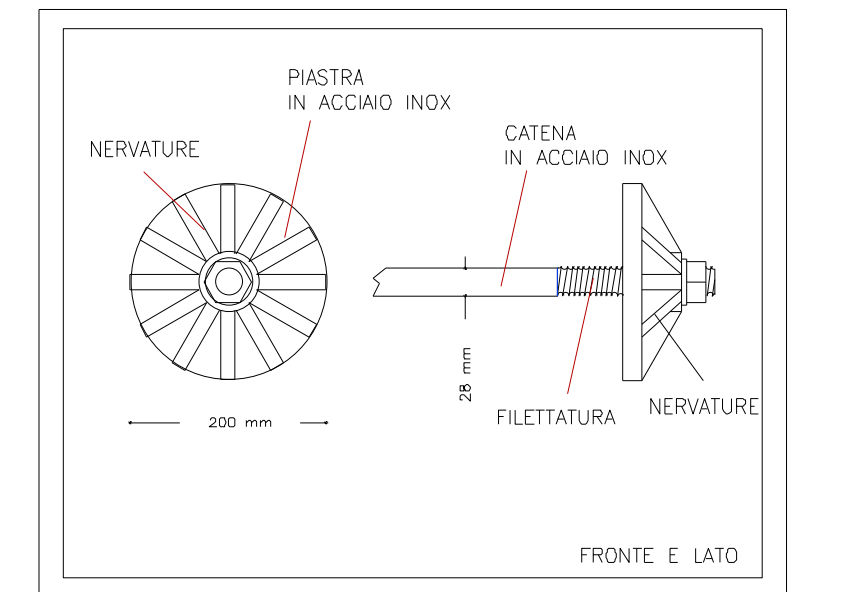

PARTICOLARE B CAPOCHIAVE A PIASTRA

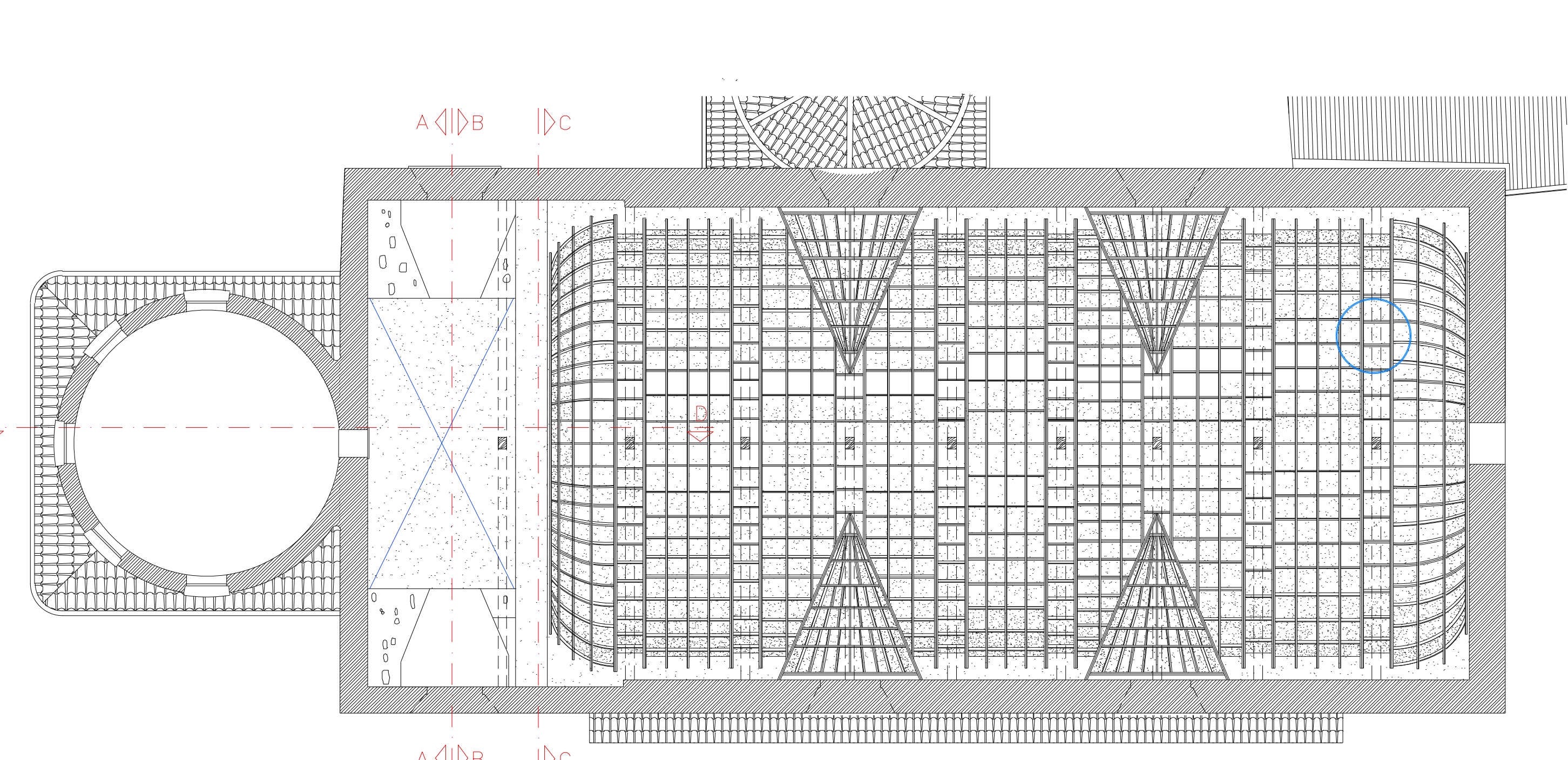
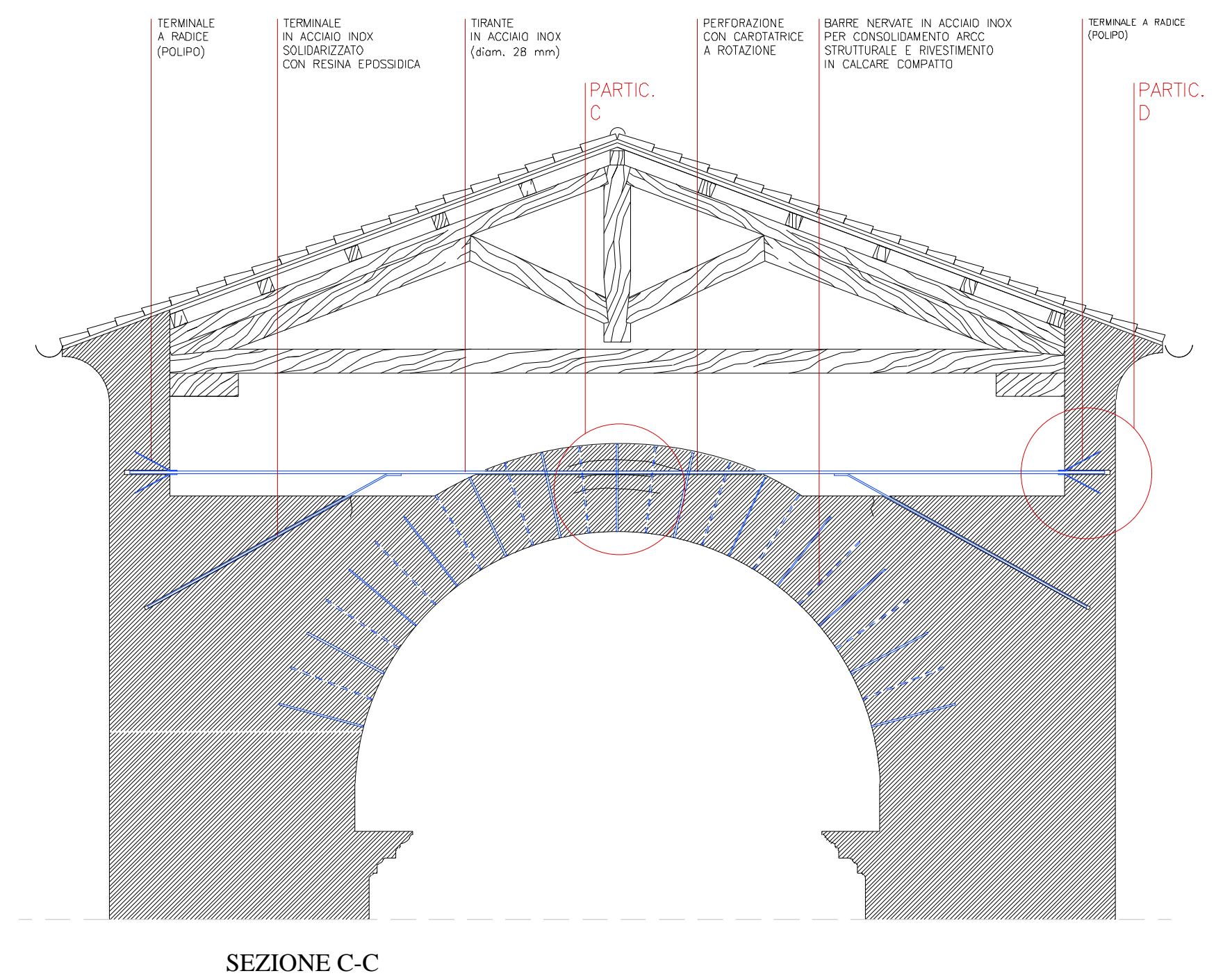

- PARTITURE ARCHITETTONICHE IN CALCIARE COMPATTO (Bronzetto)
- PARTITURE ARCHITETTONICHE IN CALCIARE COMPATTO (Membro rosato)
- PARTITURE ARCHITETTONICHE IN CALCIARE COMPATTO (Rosso Broccatello)
- PARTITURE ARCHITETTONICHE IN CALCIARE COMPATTO (Rosa Corallo)

CHIESA PARROCCHIALE DI SANT'AMBROGIO

SEZIONE C-C

A B C